

## ➤ Bevel Valve

# RJQ22

There is automatic adjustable seal gland bush between overflow outlet and slide block.

The bevel structure have big flow rate, no water hammer, no noise and credible seal performance.



### Ordering Code

|             |                       |                      |   |   |  |   |  |
|-------------|-----------------------|----------------------|---|---|--|---|--|
| <b>R</b>    | <b>JQ</b>             | <b>22</b>            | <input type="checkbox"/>  | <input type="checkbox"/>                          | <input type="checkbox"/>   | <input type="checkbox"/>                    | <input type="checkbox"/>   |
| RFS product | Angle seat valve code | Two way two position | Actuator material<br><b>S</b> stainless steel<br><b>Blank</b> aluminium<br><b>P</b> Plastic | actuator size<br>Φ40<br>Φ50<br>Φ63<br>Φ80<br>Φ100 | Connection size<br><b>10</b><br><b>15</b><br><b>20</b><br><b>25</b><br><b>32</b><br><b>40</b><br><b>50</b><br><b>65</b><br><b>80</b><br><b>100</b> | H welded type,<br>W Waterhammer<br>F flange | <b>S</b> single acting type<br><b>D</b> double acting type<br><b>K</b> normally open |

Remark: Normally open: flow comes under piston seal, against arrow on body.

### Design character

- Can see the position indication.
- Easy to install.
- Actuator adopt low abrasion piston structure, big capacity and low wastage.
- There is lubricative for inner parts, no need maintenance.
- 6.The actuator material have stainless steel,Aluminium and Plastic..
- Long life for the piston pole, PTFE seal, avoid the reif come in.
- No water hammer effect, when the liquid flowed from valve underside, the water hammer will be absorbed.

## Angle seat valve



### Specification

Orifice: DN15-DN65  
Thread: G1/8" -G2 1/2"  
Valve material: stainless steel 316  
Actuator material: Aluminium, stainless steel,plastic  
Valve core seal: PTFE  
Valve stem seal: PTFE / FKM  
Applicable medium: Water,liquid,neutral gas,oil  
water steam,weak acid or weak alkalis Solution.

Medium temperature: -10°C ~180°C  
Environment temperature: -10°C ~60°C  
Viscosity: max. 600 mm<sup>2</sup> / S  
Installation: any position  
Controlling medium: air or neutral gas  
Controlling pressure range: 0.3~1Mpa  
Liquid working pressure: 0~1.6Mpa

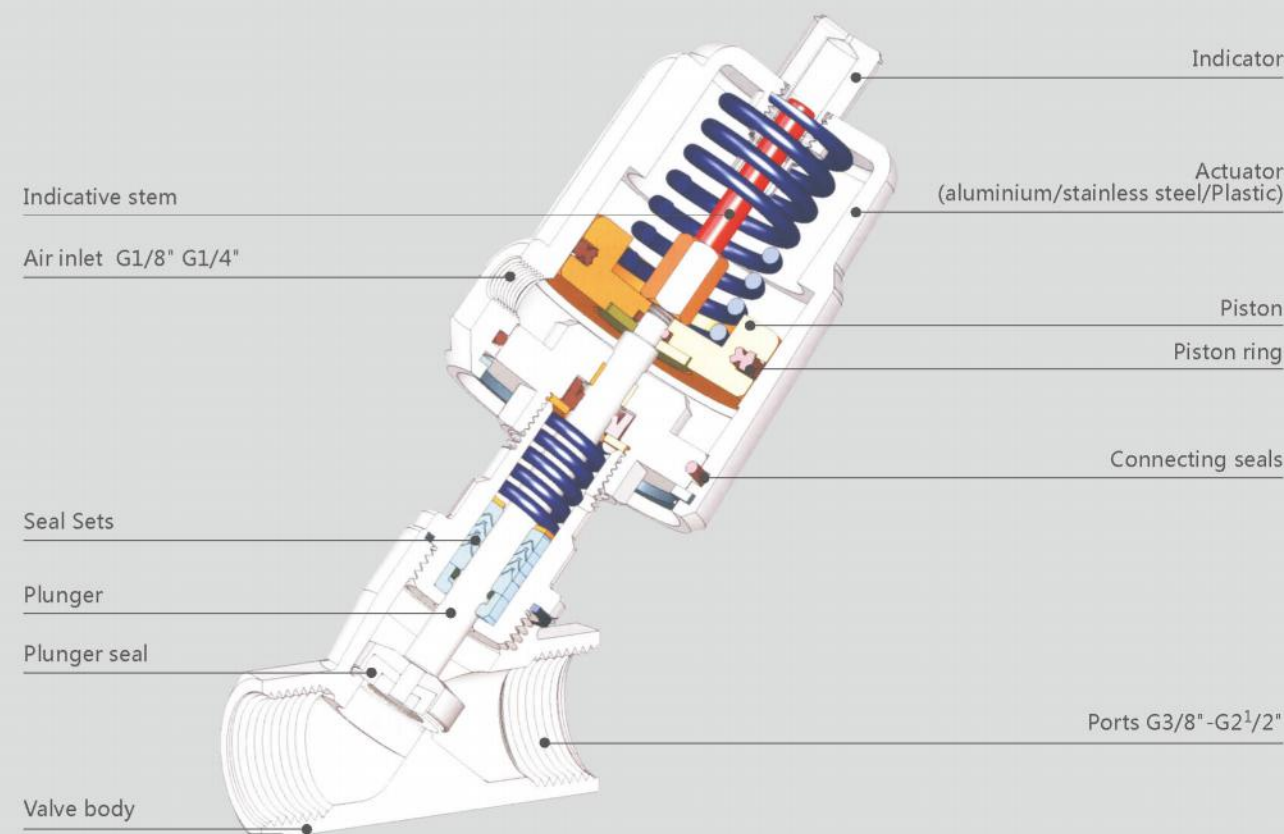

## Angle seat valve

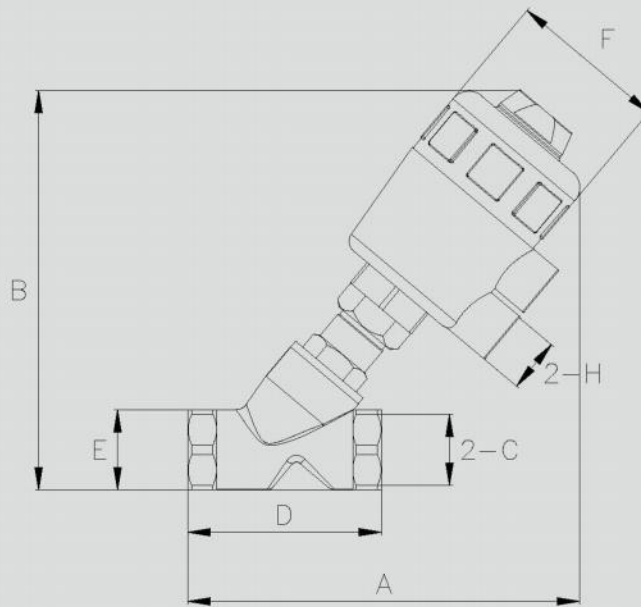

| Model       | Actuator size | A   | B   | C      | D   | E  | F   | H    |
|-------------|---------------|-----|-----|--------|-----|----|-----|------|
| RJQ22P50-10 | 50            | 148 | 158 | G3/8   | 69  | 27 | 63  | G1/4 |
| RJQ22P50-15 | 50            | 148 | 158 | G1/2   | 69  | 27 | 63  | G1/4 |
| RJQ22P50-20 | 50            | 151 | 162 | G3/4   | 75  | 32 | 63  | G1/4 |
| RJQ22P50-25 | 50            | 173 | 184 | G1     | 90  | 39 | 63  | G1/4 |
| RJQ22P63-25 | 63            | 198 | 210 | G1     | 90  | 39 | 79  | G1/4 |
| RJQ22P63-32 | 63            | 215 | 229 | G1-1/4 | 117 | 55 | 79  | G1/4 |
| RJQ22P63-40 | 63            | 215 | 229 | G1-1/2 | 117 | 55 | 79  | G1/4 |
| RJQ22P63-50 | 63            | 238 | 251 | G2     | 137 | 70 | 79  | G1/4 |
| RJQ22P80-50 | 80            | 255 | 263 | G2     | 137 | 70 | 100 | G1/4 |